



Mobile : 9830009080
9804205696
9830014165

SIDDHIVINAYAKA CONSTRUCTION

P58/40, PALLI SREE, REGENT ESTATE, KOLKATA - 700 092

Ref. No.....

Date.....

LOCATION MAP: LATITUDE AND LONGITUDE PLAN OF THE PROJECT NAMED SABARMATI at 1/21A, Adarsha Pally, PREMISES NO- 55/8, RAIPUR ROAD, WARD NO. 099, BOROUGH - X, KMC, KOLKATA - 700092, PS - NETAJI NAGAR, PO - REGENT ESTATE, WB, INDIA

Latitude: 22.48186661415058,

Longitude: 88.36268516826746

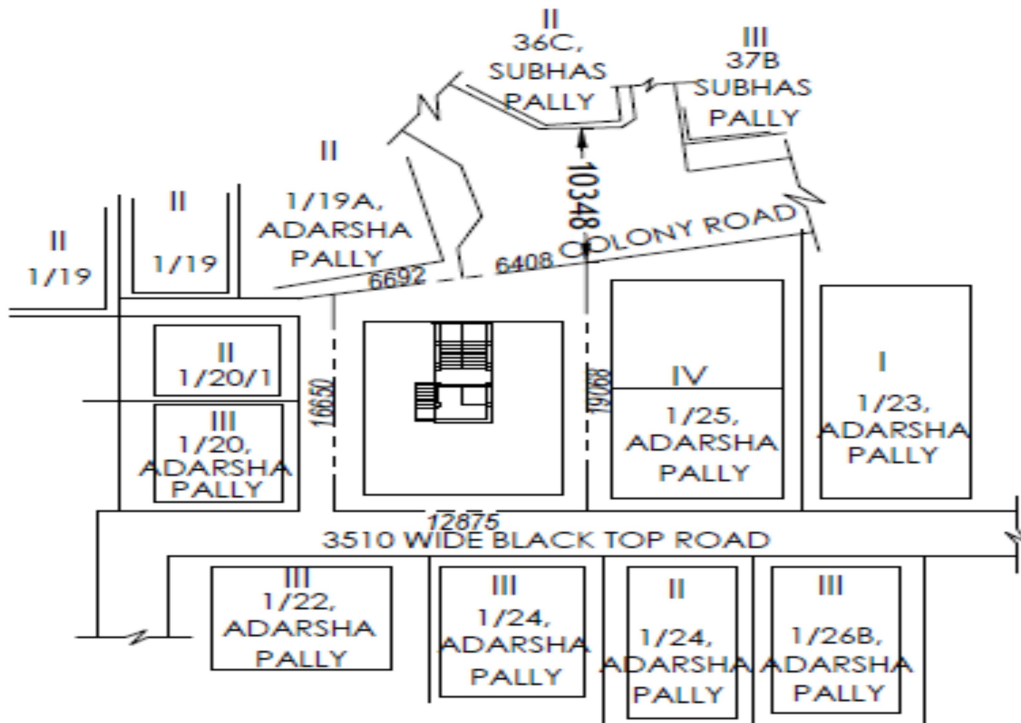

SITE PLAN

SCALE=1:600

M/s. SIDDHIVINAYAKA CONSTRUCTION

B. B. Das.

Partner

Partner